

GN 709.1 | Locking elements with threaded pin

Steel



- 1
- 2
- 3
- 4
- 5
- 6
- 7
- 8
- 9
- 10
- 11
- 12
- 13
- 14
- 15
- 16
- 17
- 18

MATERIAL

Hardened phosphated steel.

ELASTIC ELEMENT

Polyurethane (PUR).

STANDARD EXECUTIONS

Hardened steel ball:

- **GN 709.1-B**: ball with smooth and flat face, not reversible.
- **GN 709.1-BR**: ball with smooth and flat face, not reversible, with automatic return.
- **GN 709.1-R**: ball with knurled and flat face, not reversible.
- **GN 709.1-RR**: ball with knurled and flat face, not reversible, with automatic return.

Nickel-plated steel ball:

- **GN 709.1-RH**: ball with knurled and flat face, not reversible.
- **GN 709.1-RRH**: ball with knurled and flat face, not reversible, with automatic return.

FEATURES AND APPLICATIONS

GN 709.1 clamping elements are used as mobile supports or for clamping workpieces.

Maximum inclination of the ball plane = 9°.



| Conversion Table | |
|-------------------|------|
| 1 mm = 0.039 inch | |
| d1 | |
| mm | inch |
| 13 | 0.51 |
| 20 | 0.79 |
| 30 | 1.18 |
| 50 | 1.97 |

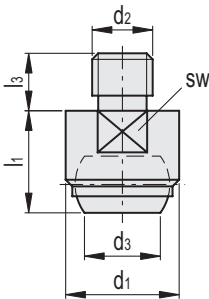

GN 709.1-B

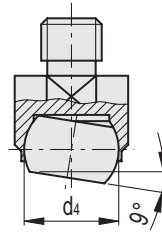

GN 709.1-BR

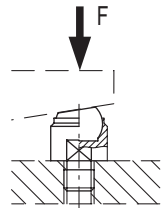
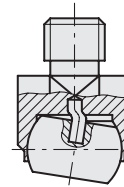

GN 709.1-B

METRIC

| Code | Description | d1 | d2 | d3 | d4 | l1 ±0.02 | l3 | sw | Max. static load F [kN] | ⚖️ |
|----------|-------------------|----|-----|------|----|----------|----|----|-------------------------|-----|
| GN.76001 | GN 709.1-13-M6-B | 13 | M6 | 7.2 | 10 | 13 | 8 | 11 | 10 | 12 |
| GN.76006 | GN 709.1-13-M8-B | 13 | M8 | 7.2 | 10 | 13 | 8 | 11 | 10 | 12 |
| GN.76011 | GN 709.1-20-M8-B | 20 | M8 | 10.5 | 16 | 18 | 10 | 17 | 25 | 38 |
| GN.76016 | GN 709.1-20-M10-B | 20 | M10 | 10.5 | 16 | 18 | 10 | 17 | 25 | 40 |
| GN.76021 | GN 709.1-20-M12-B | 20 | M12 | 10.5 | 16 | 18 | 12 | 17 | 25 | 50 |
| GN.76026 | GN 709.1-30-M16-B | 30 | M16 | 20 | 25 | 27 | 16 | 27 | 90 | 150 |
| GN.76031 | GN 709.1-50-M20-B | 50 | M20 | 34.5 | 40 | 35 | 20 | 41 | 165 | 520 |
| GN.76036 | GN 709.1-50-M24-B | 50 | M24 | 34.5 | 40 | 35 | 24 | 41 | 165 | 516 |

GN 709.1-BR

METRIC

| Code | Description | d1 | d2 | d3 | d4 | l1 ±0.02 | l3 | sw | Max. static load F [kN] | ⚖️ |
|----------|--------------------|----|-----|------|----|----------|----|----|-------------------------|-----|
| GN.76003 | GN 709.1-13-M6-BR | 13 | M6 | 7.2 | 10 | 13 | 8 | 11 | 10 | 12 |
| GN.76008 | GN 709.1-13-M8-BR | 13 | M8 | 7.2 | 10 | 13 | 8 | 11 | 10 | 13 |
| GN.76013 | GN 709.1-20-M8-BR | 20 | M8 | 10.5 | 16 | 18 | 10 | 17 | 25 | 37 |
| GN.76018 | GN 709.1-20-M10-BR | 20 | M10 | 10.5 | 16 | 18 | 10 | 17 | 25 | 39 |
| GN.76023 | GN 709.1-20-M12-BR | 20 | M12 | 10.5 | 16 | 18 | 12 | 17 | 25 | 42 |
| GN.76028 | GN 709.1-30-M16-BR | 30 | M16 | 20 | 25 | 27 | 16 | 27 | 90 | 150 |
| GN.76033 | GN 709.1-50-M20-BR | 50 | M20 | 34.5 | 40 | 35 | 20 | 41 | 165 | 486 |
| GN.76038 | GN 709.1-50-M24-BR | 50 | M24 | 34.5 | 40 | 35 | 24 | 41 | 165 | 517 |

Machine elements

1034



Models all rights reserved in accordance with the law. Always mention the source when reproducing our drawings and photos.



| Conversion Table 1 mm = 0.039 inch | |
|---------------------------------------|------|
| d1 | |
| mm | inch |
| 13 | 0.51 |
| 20 | 0.79 |
| 30 | 1.18 |
| 50 | 1.97 |

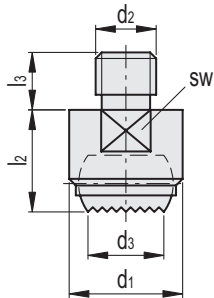

GN 709.1-R
GN 709.1-RH

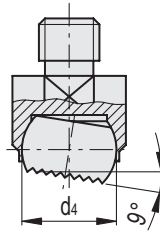

GN 709.1-RR
GN 709.1-RRH

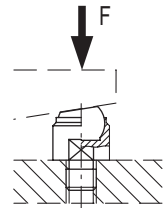
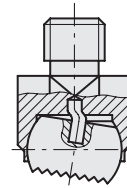

GN 709.1-R

METRIC

| Code | Description | d1 | d2 | d3 | d4 | l2 ±0.1 | l3 | sw | Max. static load F [kN] | ⚖️ |
|----------|-------------------|----|-----|------|----|---------|----|----|-------------------------|-----|
| GN.76002 | GN 709.1-13-M6-R | 13 | M6 | 7.2 | 10 | 13 | 8 | 11 | 10 | 12 |
| GN.76007 | GN 709.1-13-M8-R | 13 | M8 | 7.2 | 10 | 13 | 8 | 11 | 10 | 13 |
| GN.76012 | GN 709.1-20-M8-R | 20 | M8 | 10.5 | 16 | 18 | 10 | 17 | 25 | 38 |
| GN.76017 | GN 709.1-20-M10-R | 20 | M10 | 10.5 | 16 | 18 | 10 | 17 | 25 | 20 |
| GN.76022 | GN 709.1-20-M12-R | 20 | M12 | 10.5 | 16 | 18 | 12 | 17 | 25 | 40 |
| GN.76027 | GN 709.1-30-M16-R | 30 | M16 | 20 | 25 | 27 | 16 | 27 | 90 | 150 |
| GN.76032 | GN 709.1-50-M20-R | 50 | M20 | 34.5 | 40 | 35 | 20 | 41 | 165 | 520 |
| GN.76037 | GN 709.1-50-M24-R | 50 | M24 | 34.5 | 40 | 35 | 24 | 41 | 165 | 512 |

GN 709.1-RR

METRIC

| Code | Description | d1 | d2 | d3 | d4 | l2 ±0.1 | l3 | sw | Max. static load F [kN] | ⚖️ |
|----------|--------------------|----|-----|------|----|---------|----|----|-------------------------|-----|
| GN.75901 | GN 709.1-13-M6-RR | 13 | M6 | 7.2 | 10 | 13 | 8 | 11 | 10 | 12 |
| GN.75911 | GN 709.1-13-M8-RR | 13 | M8 | 7.2 | 10 | 13 | 8 | 11 | 10 | 13 |
| GN.75921 | GN 709.1-20-M8-RR | 20 | M8 | 10.5 | 16 | 18 | 10 | 17 | 25 | 37 |
| GN.75931 | GN 709.1-20-M10-RR | 20 | M10 | 10.5 | 16 | 18 | 10 | 17 | 25 | 39 |
| GN.75941 | GN 709.1-20-M12-RR | 20 | M12 | 10.5 | 16 | 18 | 12 | 17 | 25 | 42 |
| GN.75951 | GN 709.1-30-M16-RR | 30 | M16 | 20 | 25 | 27 | 16 | 27 | 90 | 148 |
| GN.75961 | GN 709.1-50-M20-RR | 50 | M20 | 34.5 | 40 | 35 | 20 | 41 | 165 | 482 |
| GN.75971 | GN 709.1-50-M24-RR | 50 | M24 | 34.5 | 40 | 35 | 24 | 41 | 165 | 511 |

GN 709.1-RH

METRIC

| Code | Description | d1 | d2 | d3 | d4 | l2 ±0.1 | l3 | sw | Max. static load F [kN] | ⚖️ |
|----------|--------------------|----|-----|------|----|---------|----|----|-------------------------|-----|
| GN.76004 | GN 709.1-13-M6-RH | 13 | M6 | 8.3 | 10 | 13 | 8 | 11 | 10 | 14 |
| GN.76009 | GN 709.1-13-M8-RH | 13 | M8 | 8.3 | 10 | 13 | 8 | 11 | 10 | 16 |
| GN.76014 | GN 709.1-20-M8-RH | 20 | M8 | 12.8 | 16 | 18 | 10 | 17 | 25 | 49 |
| GN.76019 | GN 709.1-20-M10-RH | 20 | M10 | 12.8 | 16 | 18 | 10 | 17 | 25 | 51 |
| GN.76024 | GN 709.1-20-M12-RH | 20 | M12 | 12.8 | 16 | 18 | 12 | 17 | 25 | 54 |
| GN.76029 | GN 709.1-30-M16-RH | 30 | M16 | 20 | 25 | 27 | 16 | 27 | 90 | 188 |
| GN.76034 | GN 709.1-50-M20-RH | 50 | M20 | 34.5 | 40 | 35 | 20 | 41 | 165 | 633 |
| GN.76039 | GN 709.1-50-M24-RH | 50 | M24 | 34.5 | 40 | 35 | 24 | 41 | 165 | 662 |

GN 709.1-RRH

METRIC

| Code | Description | d1 | d2 | d3 | d4 | l2 ±0.1 | l3 | sw | Max. static load F [kN] | ⚖️ |
|----------|---------------------|----|-----|------|----|---------|----|----|-------------------------|-----|
| GN.75906 | GN 709.1-13-M6-RRH | 13 | M6 | 8.3 | 10 | 13 | 8 | 11 | 10 | 14 |
| GN.75916 | GN 709.1-13-M8-RRH | 13 | M8 | 8.3 | 10 | 13 | 8 | 11 | 10 | 16 |
| GN.75926 | GN 709.1-20-M8-RRH | 20 | M8 | 10.5 | 16 | 18 | 10 | 17 | 25 | 48 |
| GN.75936 | GN 709.1-20-M10-RRH | 20 | M10 | 10.5 | 16 | 18 | 10 | 17 | 25 | 50 |
| GN.75946 | GN 709.1-20-M12-RRH | 20 | M12 | 10.5 | 16 | 18 | 12 | 17 | 25 | 53 |
| GN.75956 | GN 709.1-30-M16-RRH | 30 | M16 | 20 | 25 | 27 | 16 | 27 | 90 | 190 |
| GN.75966 | GN 709.1-50-M20-RRH | 50 | M20 | 34.5 | 40 | 35 | 20 | 41 | 165 | 639 |
| GN.75976 | GN 709.1-50-M24-RRH | 50 | M24 | 34.5 | 40 | 35 | 24 | 41 | 165 | 637 |

